

ITEM NO.	PART NUMBER	QTY.
1	14038	2
2	14124	5
3	17653	20
4	27322	1
5	50185-M	1
6	50181-M	2
7	50187-M	2
8	50183-M	2
9	49942	2
10	16086	2
11	14312	6
12	16530	2
13	49817	2
14	48511	4
15	50182-M	2
16	49904-M	2
17	50186-M	1
18	49614	1
19	48588-M	2
20	16101	2
21	49748	2
22	49749	2

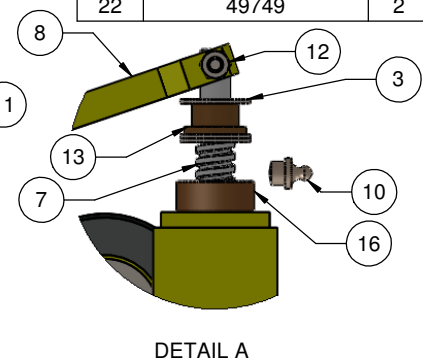

ECN	REV	DESCRIPTION	DRAWN	CHECKED	DATE	UNLESS OTHERWISE STATED	TOLERANCE UNLESS OTHERWISE SPECIFIED		PROPRIETARY AND CONFIDENTIAL	
-	A	RELEASED FOR MANUFACTURING	PWF	JD	09/08/16	- ALL SHARP EDGES TO BE GROUND R0.125" - ALL WELDS IN ACCORDANCE WITH AWS D1.1 and KWS-001 - MARK/STAMP PT. # AND/OR W.O. # ON PARTS - $\phi \pm 0.063$	X" $\pm .5"$ X.X" $\pm .25"$ X.XX" $\pm .125"$ X.XXX" $\pm .063"$ X.XXXX" $\pm .010"$ X" $\pm 1"$		THE INFORMATION CONTAINED IN THIS DRAWING IS THE SOLE PROPERTY OF HUB CITY IRON WORKS. ANY REPRODUCTION IN PART OR AS A WHOLE WITHOUT THE WRITTEN PERMISSION OF HUB CITY IRON WORKS IS PROHIBITED.	
	B					MATERIAL	3rd ANGLE PROJECTION	TITLE: FRONT LANCE SUPPORT ASSEMBLY		
	C					N/A		DWG. No: 107-701-174-00		
	D					COATING		SAP. No: 49836 WT:50.161 LBS SHEET 1 OF 1		
	E					N/A		REV: A		
						DO NOT SCALE ALL DIMENSION IN INCHES				
I	H	G	F	E	D	C	B	A		

001-101-005 REV A C:\00ENGRVAULT\Products\107 - Pipe Cleaning Machine\701 - Mechanical Sub Assemblies