

ITEM NO.	PART NUMBER	DESCRIPTION	QTY.
1	28991	NEEDLE BEARING RACER, W. FLANGE	1
2	43532	GREASE FIT	1
3	13979	WASHER, BRASS	2
4	14641	NEEDLE BEARING	1
5	49723	HEX IDLE WHEEL SHOULDER BOLT	1
6	16485	NUT, HEX, .75" NC	1
7	22531	WHEEL, SMOOTH	1
8	17653	WASHER, FLAT, .75"	1
9	17652	WASHER, FLAT, 1"	1
10	14133	WASHER, LOCK, .75"	1

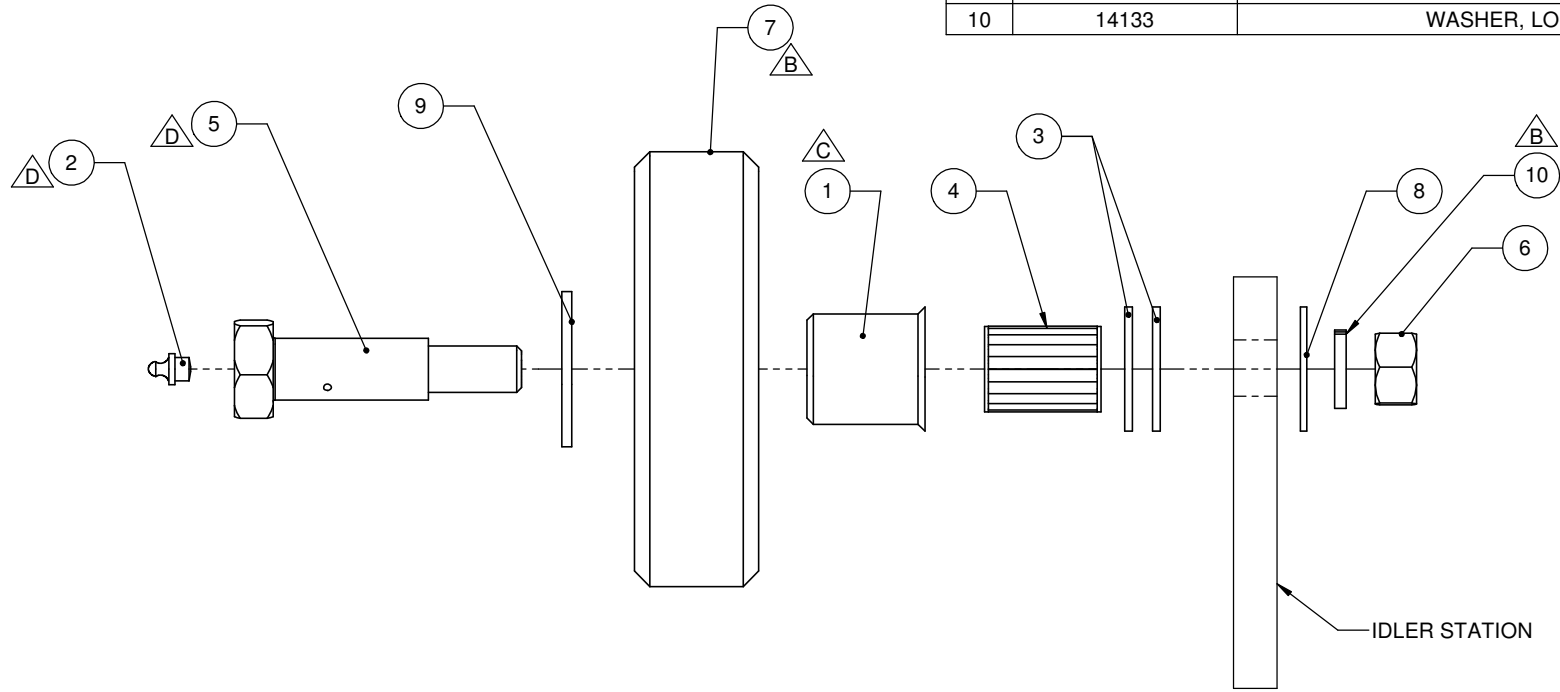

ECN	REV	DESCRIPTION	DRAWN	CHECKED	DATE	UNLESS OTHERWISE STATED	TOLERANCE UNLESS OTHERWISE SPECIFIED	PROPRIETARY AND CONFIDENTIAL	
-	A	RELEASED FOR MANUFACTURING	PWF	SH	09/30/11	- ALL SHARP EDGES TO BE GROUND R0.125" - ALL WELDS IN ACCORDANCE WITH AWS D1.1 and KWS-001 - MARK/STAMP PT. # AND/OR W.O. # ON PARTS - $\phi \pm 0.063$	X" $\pm .5"$ X.X" $\pm .25"$ X.XX" $\pm .125"$ X.XXX" $\pm .063"$ X.XXXX" $\pm .010"$ X" $\pm 1"$	THE INFORMATION CONTAINED IN THIS DRAWING IS THE SOLE PROPERTY OF HUB CITY IRON WORKS. ANY REPRODUCTION IN PART OR AS A WHOLE WITHOUT THE WRITTEN PERMISSION OF HUB CITY IRON WORKS IS PROHIBITED.	
	B					MATERIAL		TITLE: <b>IDLE WHEEL ASSEMBLY</b>	
	C					COATING	3rd ANGLE PROJECTION	DRAWN:	BY: DATE:
	D					N/A		CHECKED:	PWF 05/10/11
	E					DO NOT SCALE ALL DIMENSION IN INCHES		APPROVED:	SH 09/30/11
									SH 06/20/17
I		H	G	F	E	D	C	B	A
								DWG. No:	REV: <b>D</b>
								107-701-028-00	
								SAP. No:	WT: LBS SHEET 1 OF 1