

PIPE PRELOADER, RACK MOUNTED

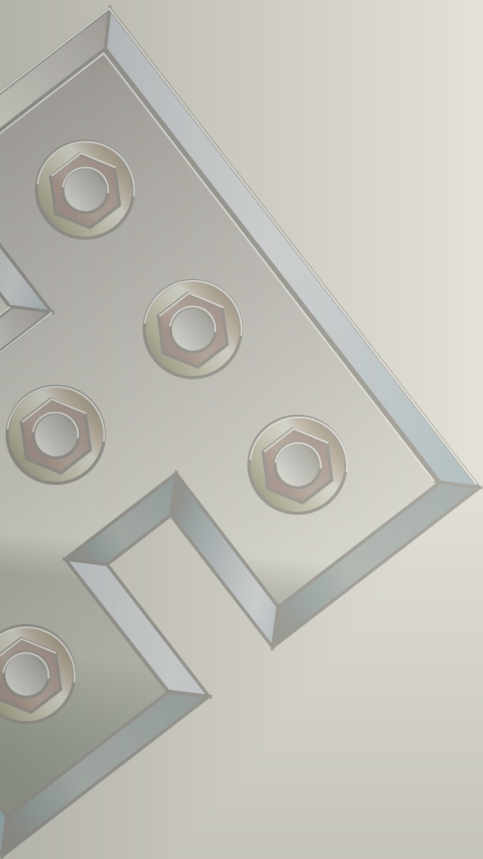

The Pipe Preloader is used to maintain a queue of pipe that is ready for loading into conveyors, Pipe Cleaning Machines and various other pieces of equipment. It functions by providing a slope for the pipe to roll upon until reaching a pipe stop. Preloaders may be used in a single configuration or placed in-line so that one Preloader can feed the other.

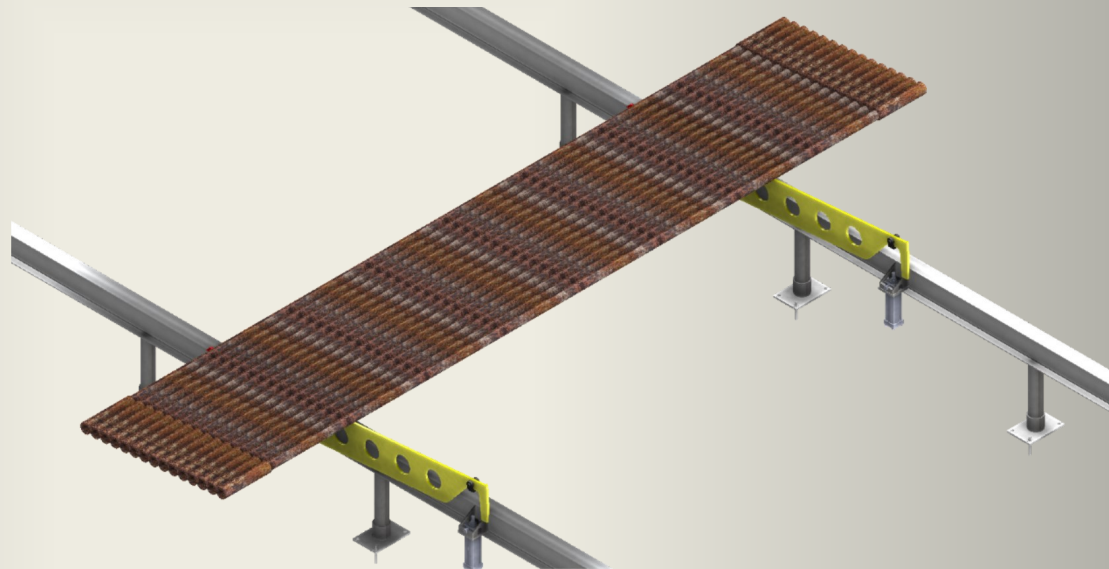

Capacity

Length of Preloader	12'
Max Weight per linear foot	10,000 lbs per arm

Hub City Iron Works
Phone: 1.337.334.6969

Email: sales@hubcityironworks.com
Website: www.hubcityironworks.com